

## Custom Binder

**Summary:** When an item is too large in height and/or width to fit in the prefabricated pamphlet binders in stock, a custom binder is created to accommodate the oversize pamphlet and/or pocket.

### Tools and Materials:

- Gray/White Barrier Board
- Teflon folder
- PVA Adhesive
- Weights
- 3" roll of Buckram bookcloth
- Ruler/straight edge
- PVA Brush
- Corner rounder
- Pencil
- Scrap paper
- Knife
- Board shear

### Procedure:

**Board:** Cut two pieces of gray/white board to a height approximately  $\frac{1}{2}$  inch taller than the item. To determine width, keep in mind that the cloth spine adds to the width of what will be covering the pamphlet, but a pocket must be fully supported by the boards. Excess in width can always be trimmed off the fore-edge at the end if needed. Grain direction should be parallel to the spine. Choose which of the spine paralleling edges has the neatest cut for each board and round those corners to indicate the fore-edge.

**Cloth:** Rough cut one strip of cloth about two inches taller than the board height. Cut a second strip more precisely to approximately  $\frac{1}{2}$  inch shorter than the board height.

Make pencil marks on the gray/blue outer side of the board 1 inch from the spine edge. Turn the longer piece of bookcloth upside down and line it up with the pencil marks. A weight can be placed on top to help hold the cloth in place while gluing.

Using a wide brush to spread the PVA, apply a thin layer of adhesive such that some goes over the edge of the cloth in addition to covering the exposed 1" of board. Brush strokes should always be towards the spine edge for this process.

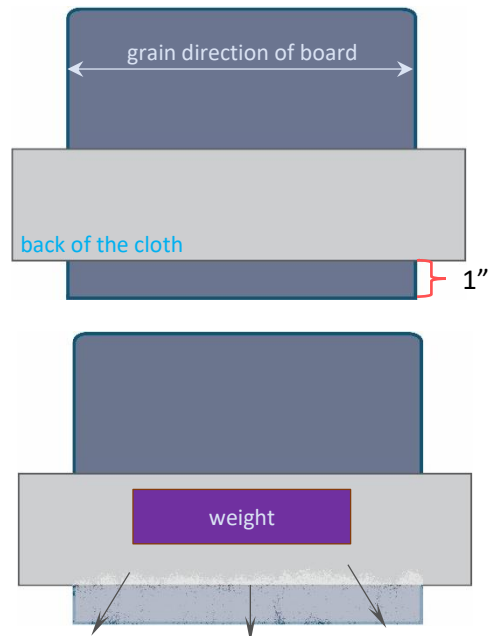

Remove the weight and flip the cloth over to have it cover 1 inch of the spine edge. Use a Teflon folder to ensure that the cloth has adhered securely. This is also an opportunity to clean up any glue that has seeped out the edges. If there is a lot of glue oozing out, use less glue next time.

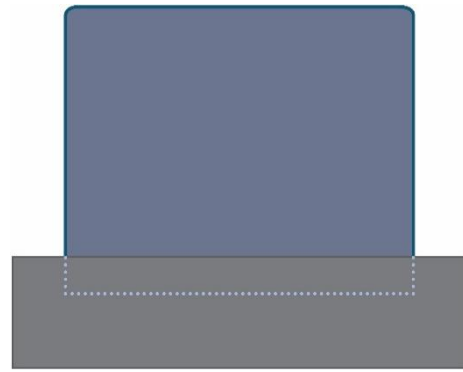

Make pencil marks 1 inch from the edge of the cloth (darker is better, so that it is possible to see through the glue). Use scrap paper to mask off the top and bottom turn-ins and to protect the worksurface. Apply PVA to the cloth where it will attach to the second board. Brush strokes should be towards the edge of the cloth.

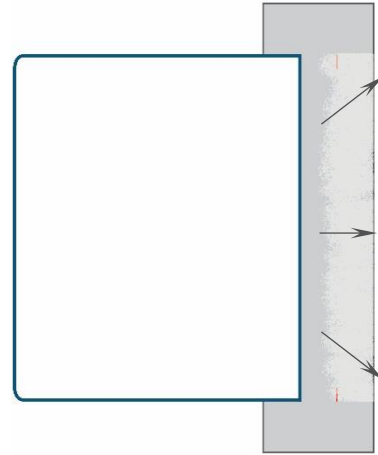

Using a straight edge and weights as needed, line up the second board to the first vertically. Use the pencil marks on the cloth to line the board up horizontally. Apply pressure to the board to secure it, and then flip everything over and use a Teflon folder apply pressure directly to the cloth. Clean up excess glue before it has a chance to dry.

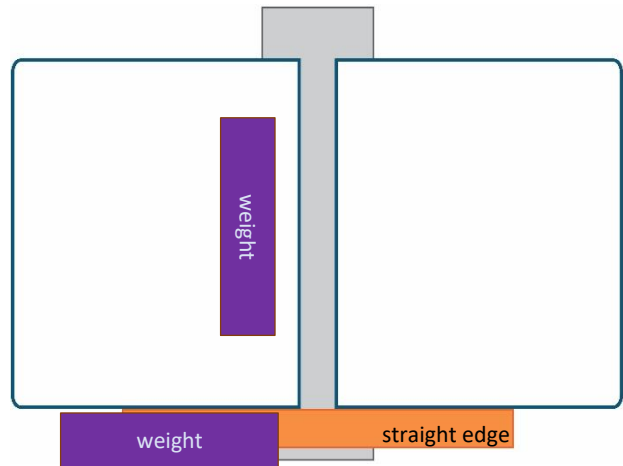

Use the straight edge to trim the oversize cloth turn-ins.

Apply PVA to the turn-ins and fold them over the edges of the boards. Use a teflon folder to ensure that they adhere to the board and cloth.

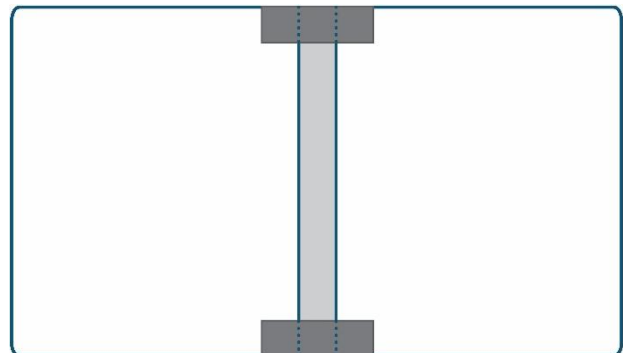

Glue out the shorter piece of cloth on a piece of scrap paper. Apply it first to one board lining up the edges of your already adhered turn-ins. Using a Teflon folder, work the cloth over the edge of the board, through the middle cloth piece and over the other board. Use the point of the folder to ensure the crease where the cloth meets the board is adequately adhered.

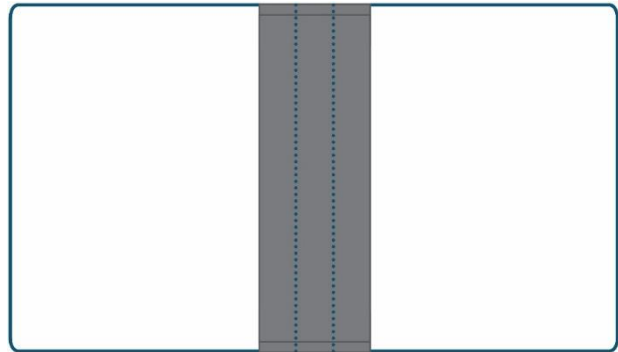

Let dry. Fold in half and check at the head and tail to make sure the edges of the cloth have adhered. The bookcloth doesn't like to adhere to itself, so use a microspatula to apply more PVA to any loose areas.