

HOW TO MOUNT 133m² OF 18th CENTURY FLAG

Deborah Phipps, Textile Conservator & Katie Jeffs, 3D Designer
Norfolk Museums Service

**CONSERVATION &
DESIGN SERVICES**









Option 01 – To display the Ensign flat by building a plinth which fits the entire span of the first gallery. The ensign is approximately 50mm taller than the width of the gallery so we need a slight ripple.

This would require a suspended walkway and calculations made to ensure the air handling unit wouldn't be effected. The doors to the gallery would have to be removed to make the walkway over the object accessible as it will have to be a gradual slope.

Option 02 – To display the Ensign at a slight angle/ripple, allowing space for a floor supported walkway on one side of the gallery. This would require reducing the height of the ensign by approximately 1.5m to 2m within a ripple and displaying it at approximately 10 degree angle. I'm not sure if this is doable so we'd need to do a test with a mock-up flag.

Again we would need a consultant to advise on the air handling unit and the gallery doors would need to be removed to make the side walkway accessible.

Option 03 – To display the Ensign rolled to reduce the height and replicate the remainder with a printed version or floor vinyl's so the scale and shape is still interpreted.

Option04 –We agreed a large angled plinth is not suitable as the Ensign is too fragile to take the weight from top to bottom it could it be angled left to right. If we changed the entrance to the gallery, we could build a plinth at a 10 degree angle so you can view the whole of the flag.

Option05 – To display overhead by creating an acrylic platform. This will require a framework, will not look seamless and be extremely costly.

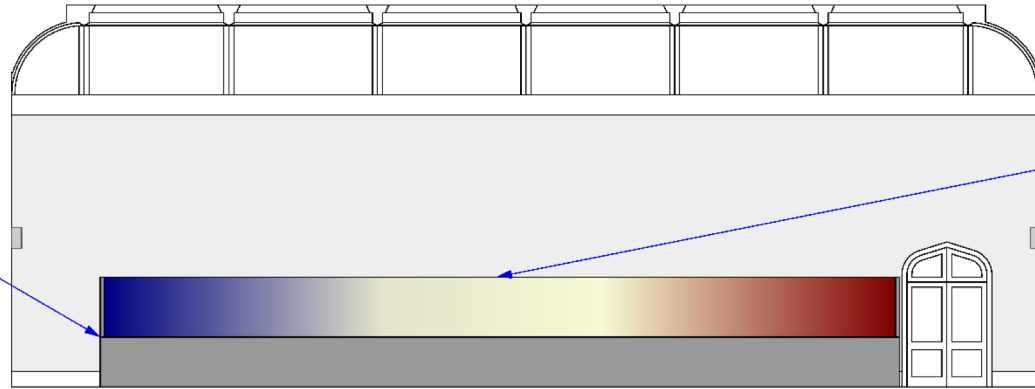

Object to be rippled to reduce height. Approx 2m to be lost from height.

Ventilation to be consulted with air handling unit supplier

Doors removed and external glass box covered with graphics.

Plinth at a 10 degree angle.

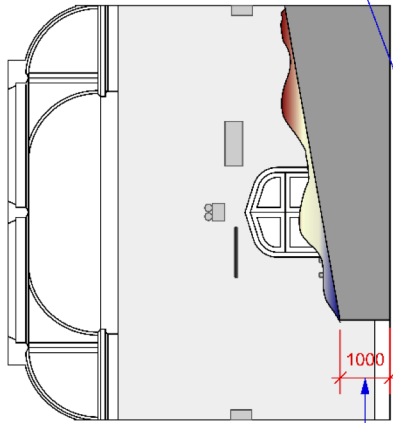

1000

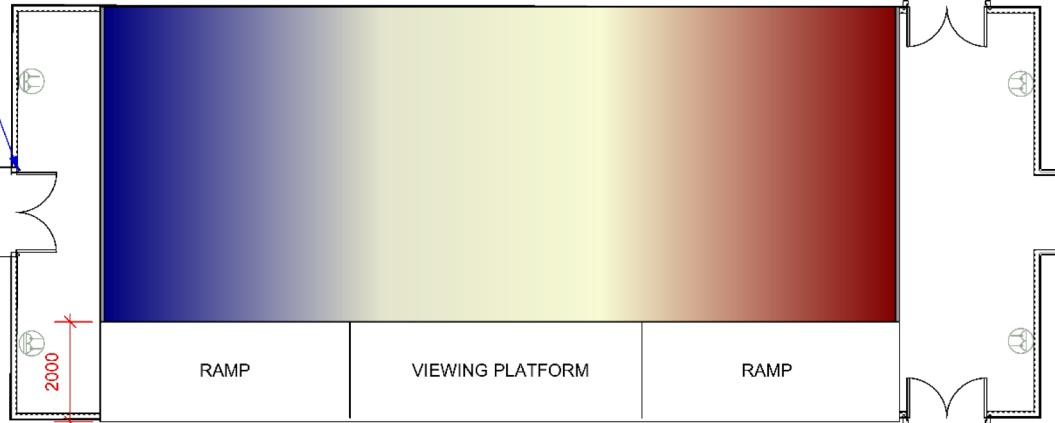

2000

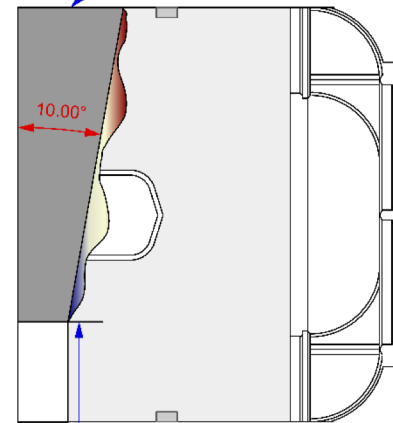

10.00°

Barrier with interpretation/graphic band across

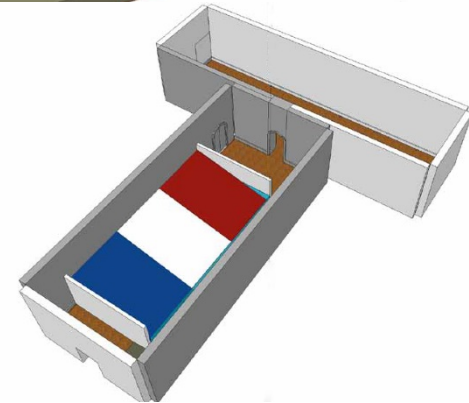
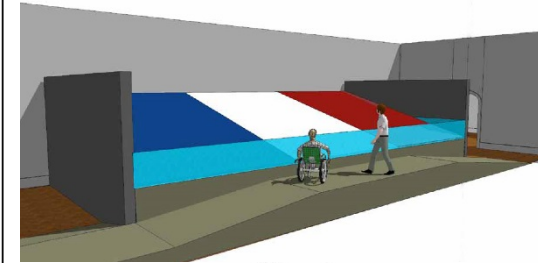

Height of plinth to be consulted with air handling unit supplier.

Angle of ramp to be calculated for accessibility.

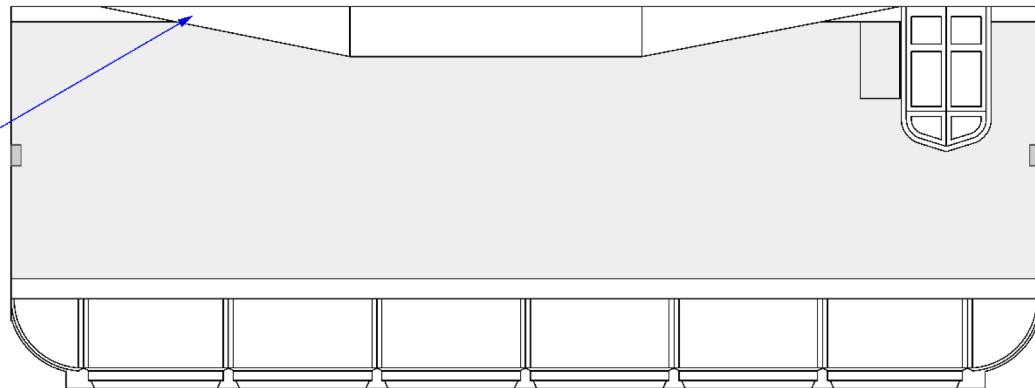

Ensign Option02

Paper: A3	Dims: mm	Sheet 1 of 1
10.10.16	Scale: 1:100	Dwg No: N001

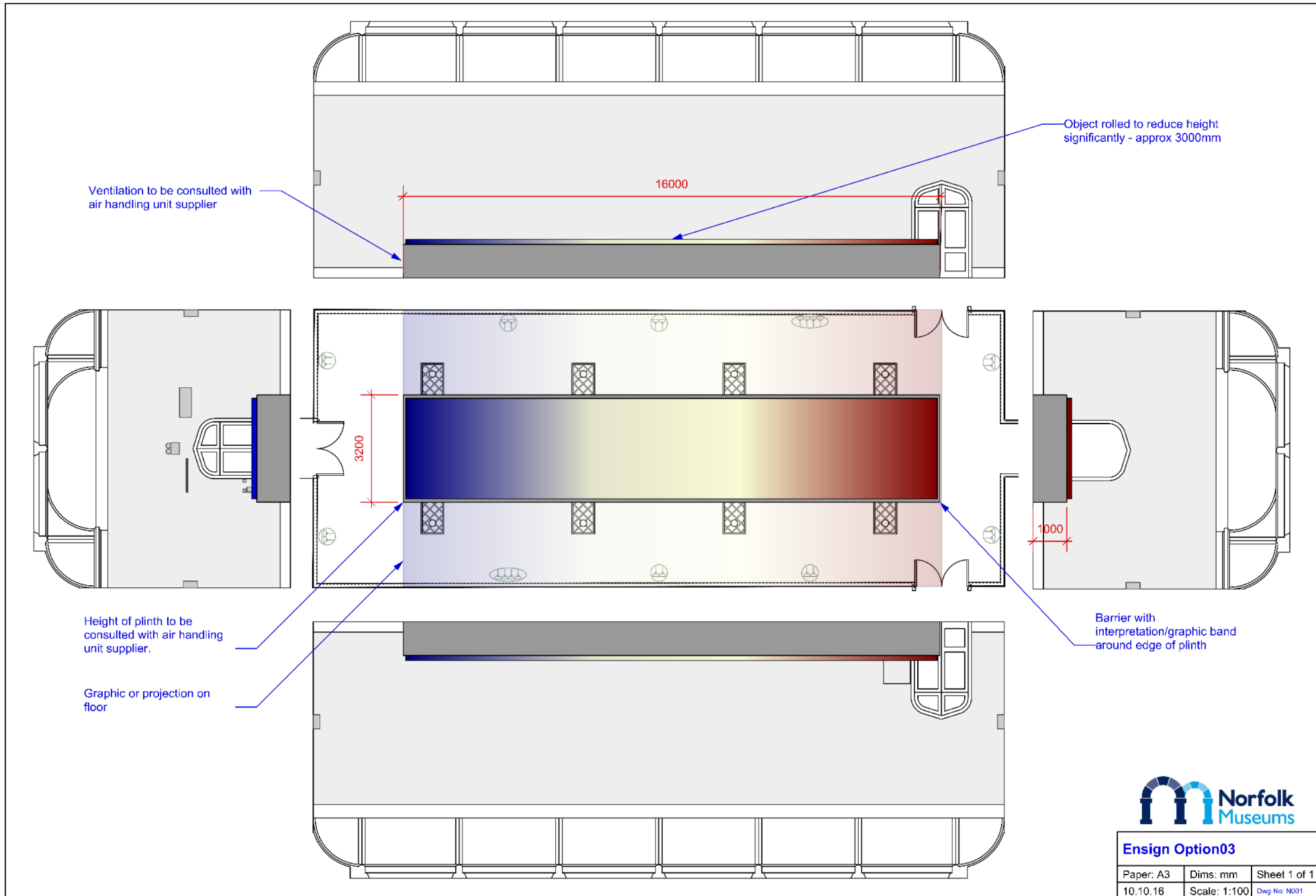
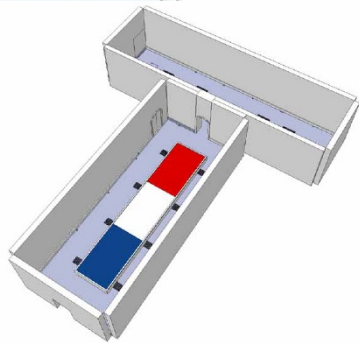
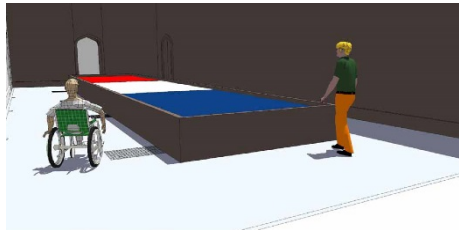

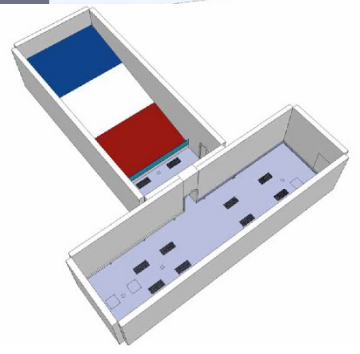
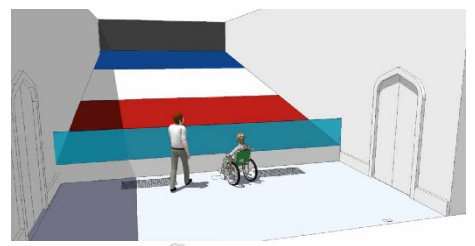
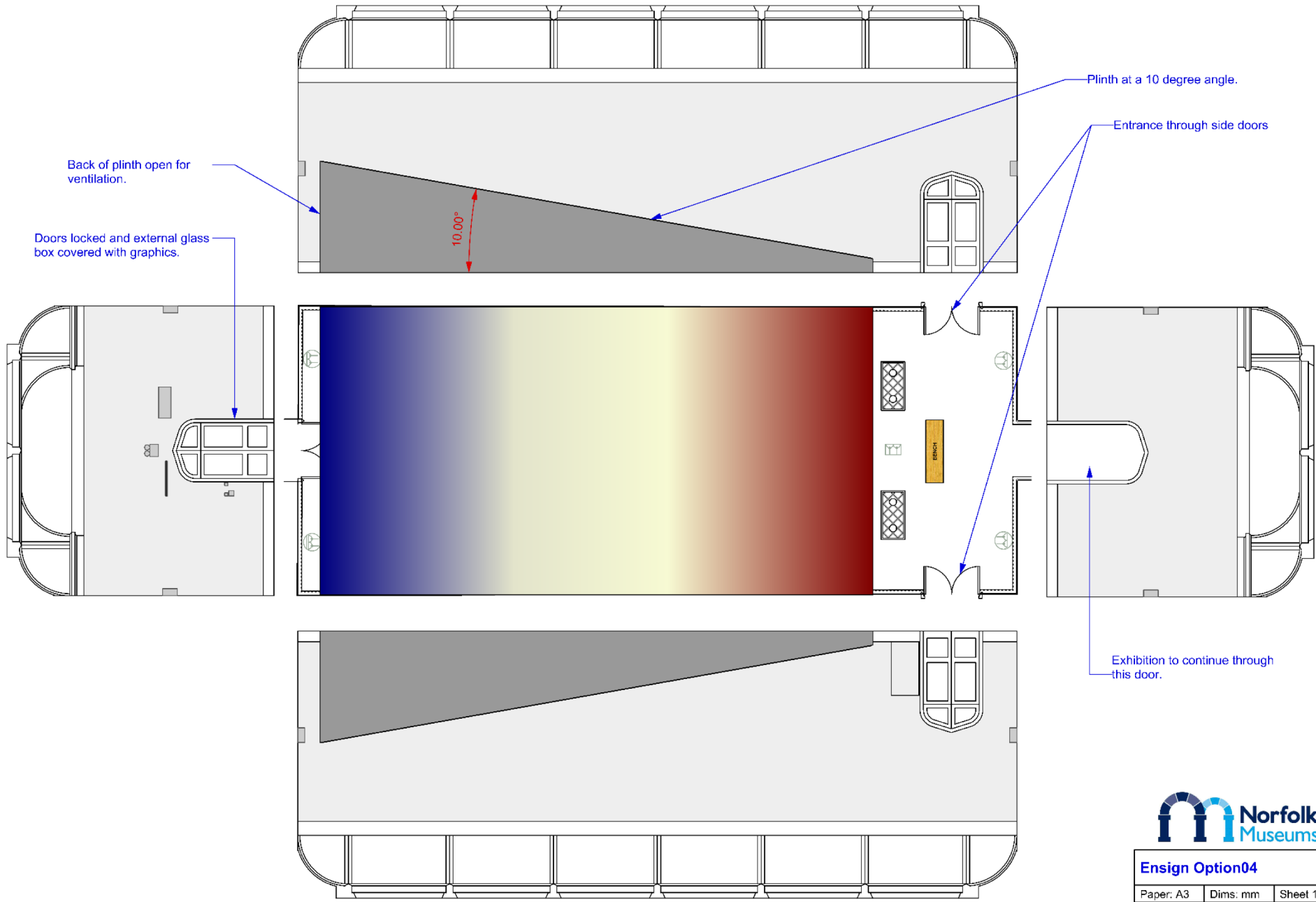

Ensign Option04

Paper: A3	Dims: mm	Sheet 1 of 1
10.10.16	Scale: 1:100	Dwg No: N001

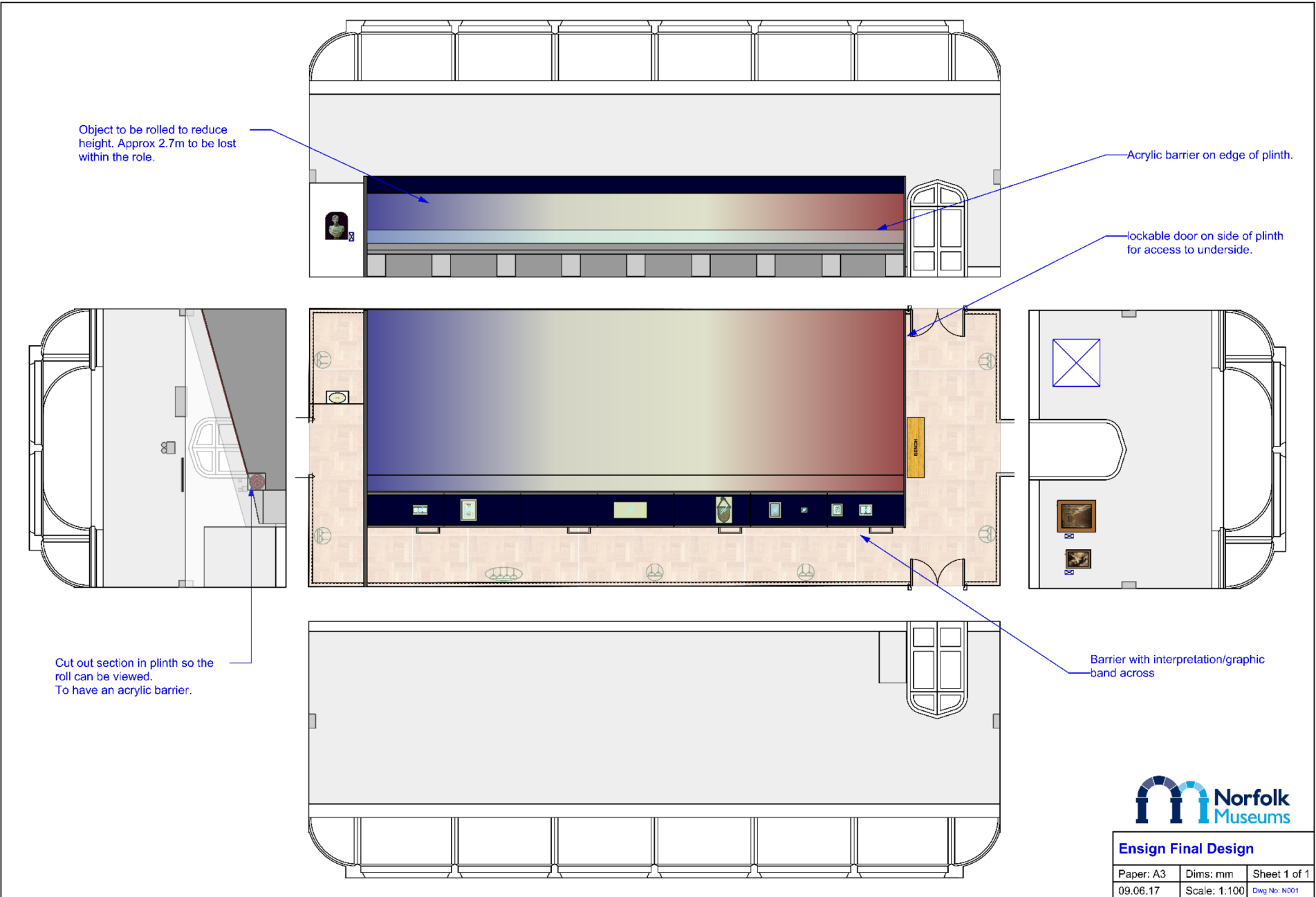

Ensign Final Design

Paper: A3	Dims: mm	Sheet 1 of 1
09.06.17	Scale: 1:100	Dwg No: N001

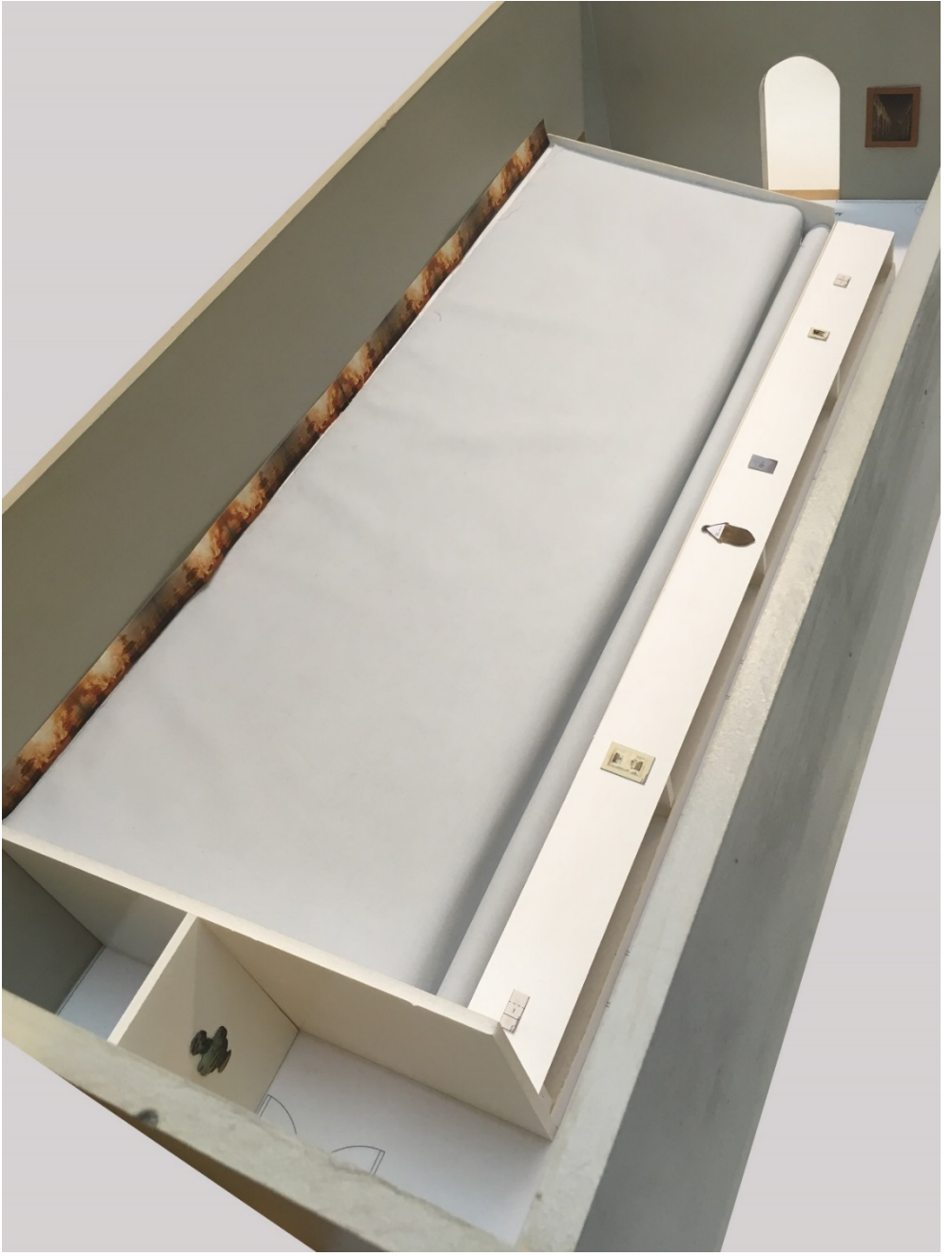
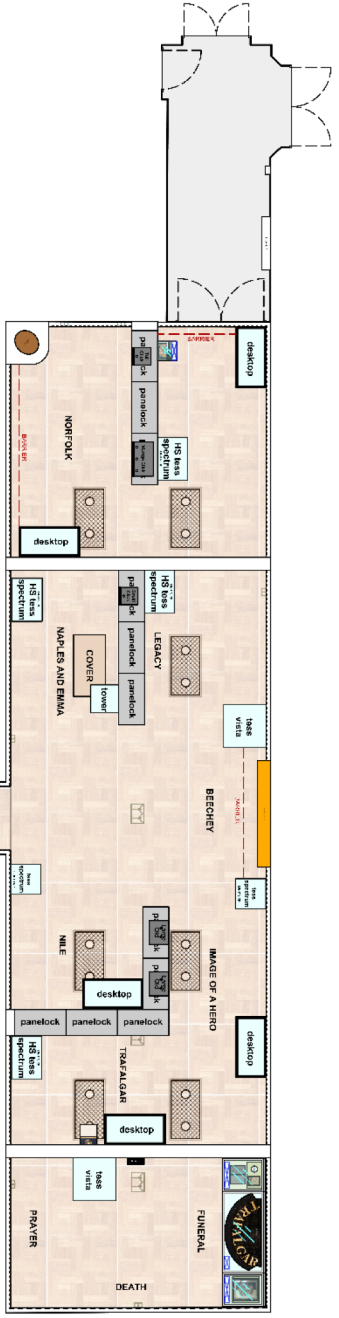
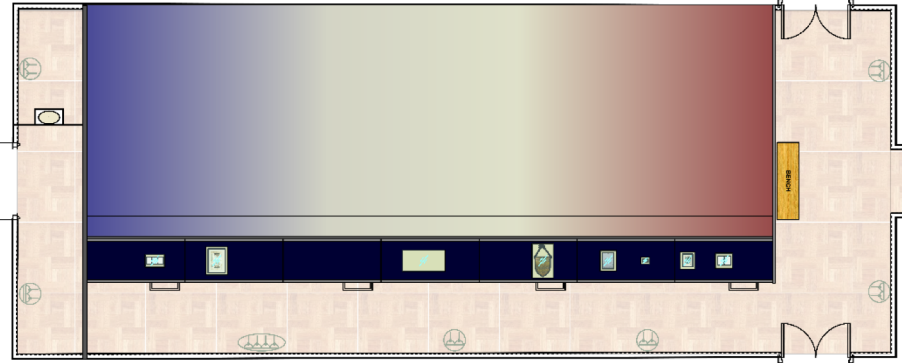

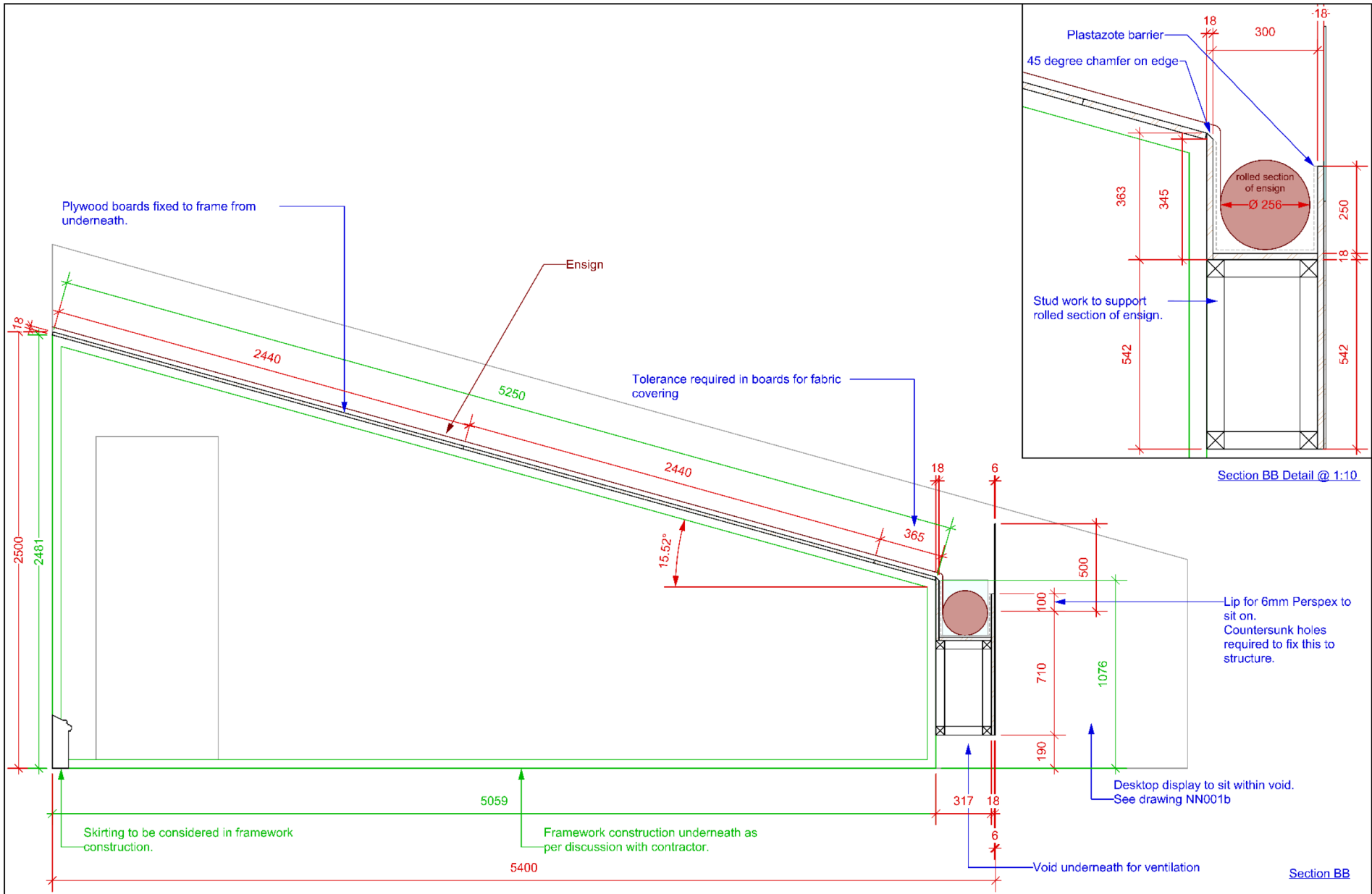

Section BB Detail @ 1:10

Section BB













